



Pentures, serrures
et pièces de fixation
Locks and patch fittings

ASSA ABLOY

Pentures,
serrures et
pièces de fixation
*Locks and
patch fittings*

Cilindric®



Caractéristiques techniques

- Dimensions \varnothing 55 mm hauteur 75 mm
- Inox AISI 304
- Pour verre de 8, 10 et 12 mm
- Montage sur encoche
- Poids maximum 100 kg

Technical features

- Dimensions \varnothing 55 mm height 75 mm
- Stainless steel 304
- For 8, 10 and 12 mm thick glass
- Assembly on notch
- Maximum door weight 100 kg

LES + PRODUITS

The + product

Design High Tech

Grande qualité
de finition

Résistance

Modularité

Inox massif

High tech design

High quality finishes

Resistance

Modularity

Solid stainless Steel

C500D

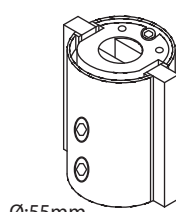

\varnothing :55mm
height:75mm

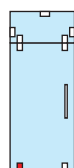
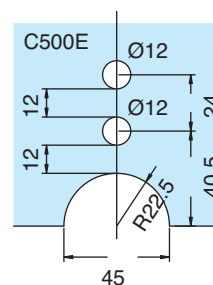

Références / References



Penture basse empreinte pour axe allemand
Bottom patch fitting German insert



Inox Brossé
Brushed stainless steel

C500D.15

C500I

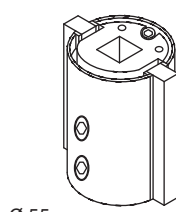

\varnothing :55mm
height:75mm

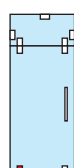
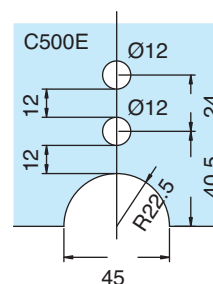

Références / References



Penture basse empreinte pour insert italien
Bottom patch fitting Italian insert



Inox Brossé
Brushed stainless steel

C500I.15

Pentures,
serrures et
pièces de fixation
*Locks and
patch fittings*

C501

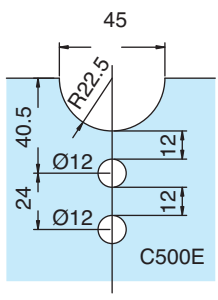
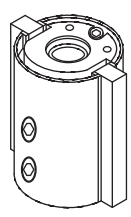

Ø:55mm
height:75mm

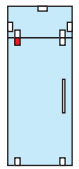

Références / References



Penture haute
Top patch fitting



Inox Brossé
Brushed stainless steel

C501.15

C502

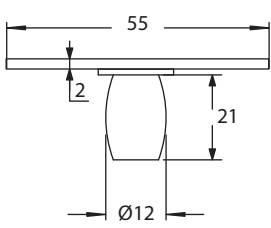

Références / References

Pivot haut, fixation linteau ou plafond
Top pivot, fixing lintel or ceiling



Inox Brossé
Brushed stainless steel

C502.15

C511

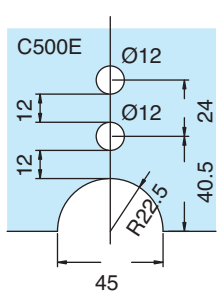
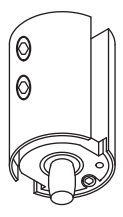

Ø:55mm
height:75mm

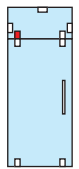

Références / References

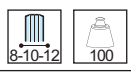

Contre-sabot d'imposte avec pivot
Transom panel patch with pivot



Inox Brossé
Brushed stainless steel

C511.15

Pentures,
serrures et
pièces de fixation
*Locks and
patch fittings*

AC299.33

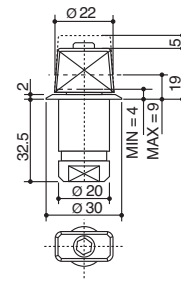

Crapaudine à sceller réglable axe rectangulaire allemand
Adjustable German rectangular floor pivot, to be embedded



AC246.33

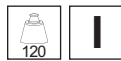
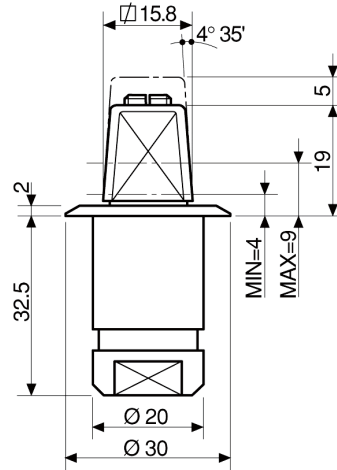

Crapaudine à sceller réglable axe carré italien
Adjustable Italian square floor pivot, to be embedded

V502

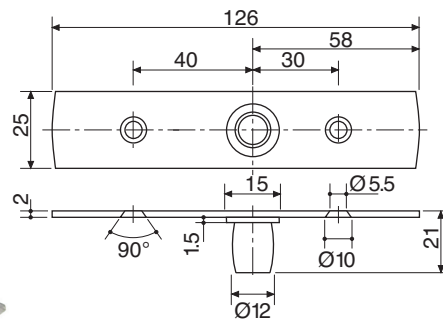

Références / References

Pivot supérieur pour V501/V201
Offset top pivot for V501/V201

Inox Brossé
Stainless steel effect

V502.15

Pentures,
serrures et
pièces de fixation
*Locks and
patch fittings*

C528A

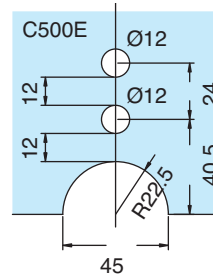
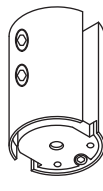

Références / References



Pièce de fixation pour panneaux fixe
Wall to glass patch for transom or fixed panel

C528A.15

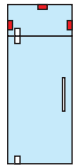

C528B

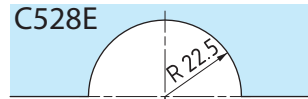
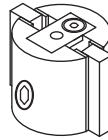
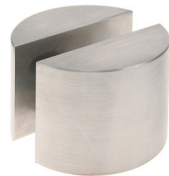

Références / References



Cilindric pièce de fixation pour panneaux fixe hauteur 35 mm
Cilindric wall to glass patch for transom or fixed panel height 35mm

C528B.15

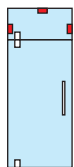

C581

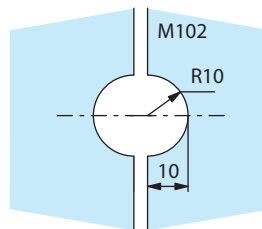
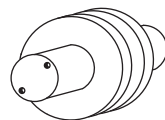

Références / References



Pièce de liaison pour 2 glaces fixes modèle rond / simple
Connector for 2 fixed panels single rounded model

C581.15

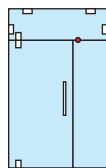

C582

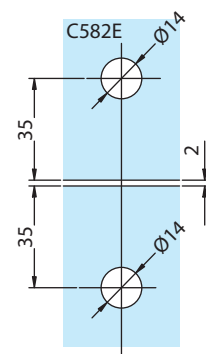
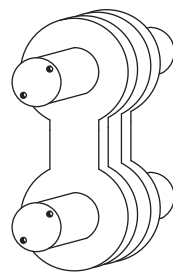

Références / References



Pièce de liaison pour 2 glaces fixes modèle '8'
Connector for 2 fixed panels '8' shape

C582.15

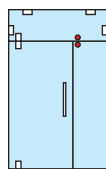

C583

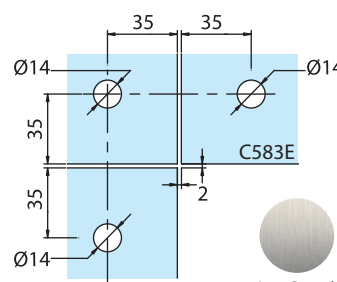
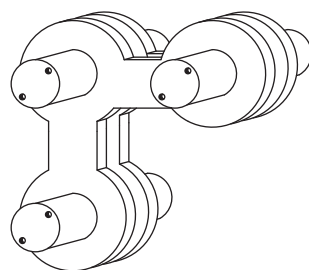

Références / References



Pièce de liaison pour 3 glaces fixes
Connector for 3 fixed panels

C583.15

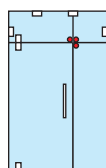

Pentures,
serrures et
pièces de fixation
*Locks and
patch fittings*



C222L

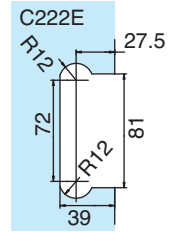
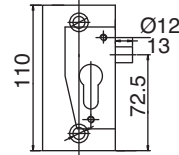
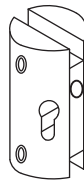

Inox Brossé
Brushed stainless steel

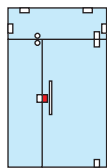

Références / References



Serrure bord de verre gauche extérieur, sans cylindre et sans gâche
Lock on left outside edge of glass, supplied without cylinder and flat keep

C222L.15

C222R

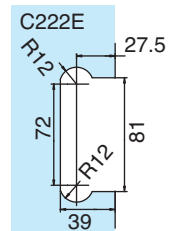
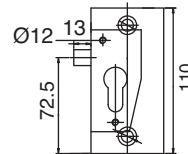
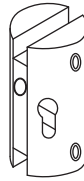

Inox Brossé
Brushed stainless steel

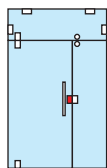

Références / References



Serrure bord de verre droite extérieur, sans cylindre et sans gâche
Lock on right outside edge of glass, supplied without cylinder and flat keep

C222R.15

C223L

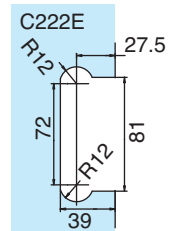
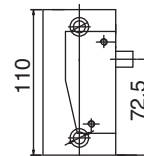
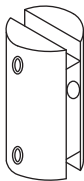

Inox Brossé
Brushed stainless steel

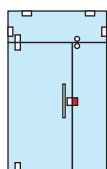

Références / References



Contre-boîtier pour serrure, bord de verre gauche extérieur
Patch keep on left side edge of fixed panel

C223L.15

C223R

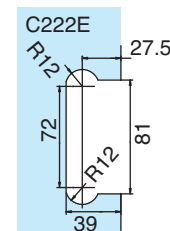
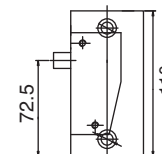
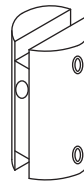

Inox Brossé
Brushed stainless steel

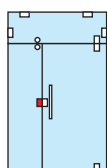

Références / References



Contre-boîtier pour serrure, bord de verre droit extérieur
Patch keep on right side edge of fixed panel

C223R.15

Pentures, serrures et pièces de fixation
Locks and patch fittings

C517

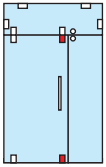
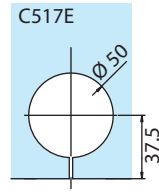
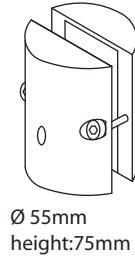

Références / References



Serrure à clé sans gâche
Lock with key without flat keep



Inox Brossé
Brushed stainless steel

C517.15

C529

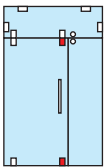
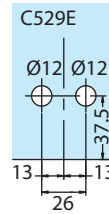
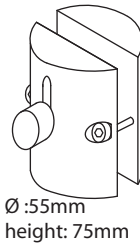

Références / References



Serrure à pieds sans gâche
Foot operated lock without flat keep



Inox Brossé
Brushed stainless steel

C529.15

Poignées
Handles

C600PG22



Références / References



Inox Brossé
Brushed stainless steel

Poignées Ø 45 mm, avec serrure 2 points d'un côté,
hauteur maxi : 2200 mm
Handle 45 Ø mm with 2 point lock on one side, height max : 2200 mm

C600PG22.15

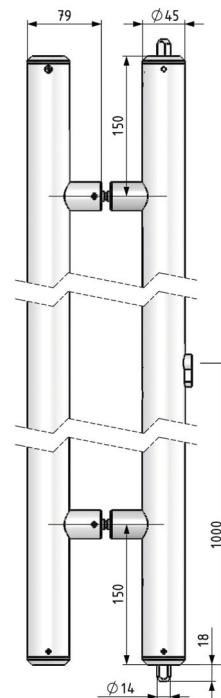

LES + PRODUITS

The + product

Esthétique

Double fonction :
tirage et verrouillage

Robustesse

Porte grande
hauteur

Attractive design

Double function :
pull and lock

Resistant

For high doors

C600PG30

Références / References



Inox Brossé
Brushed stainless steel

Poignées Ø 45 mm, avec serrure 2 points d'un côté,
hauteur entre 2200 mm et 3000 mm maxi
Handle 45 Ø mm with 2 point lock on one side, height max between 2200 mm and 3000 mm

C600PG30.15

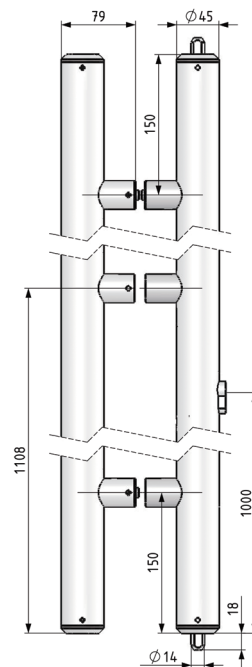

C601PG22

Références / References



Poignées Ø 45 mm, hauteur maxi : 2200 mm
 Handle 45 Ø mm height max 2200 mm



Inox Brossé
 Brushed stainless steel

C601PG22.15

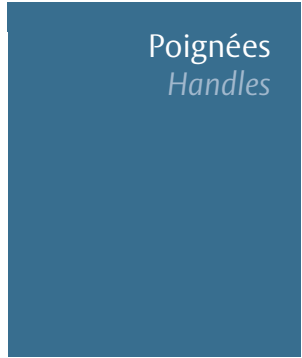
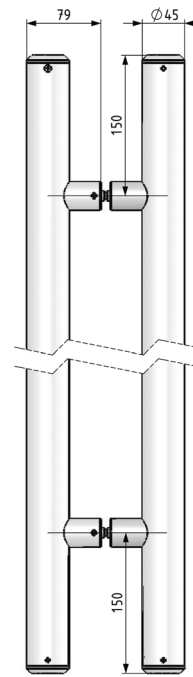

C601PG30

Références / References

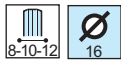

Poignées Ø 45 mm, hauteur entre 2200 mm et 3000 mm maxi
 Handle 45 Ø mm, height max between 2200 mm and 3000 mm



Inox Brossé
 Brushed stainless steel

C601PG30.15

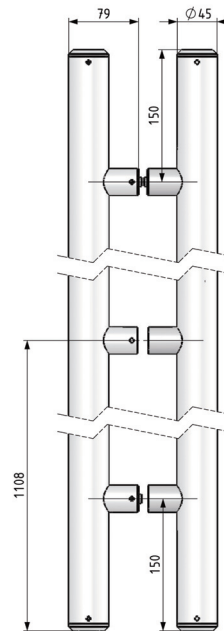

Poignées
Handles

C532



Références / References

Gâche pour poignée C600-C602
Keep plate for C600-C602



C532.15



C541

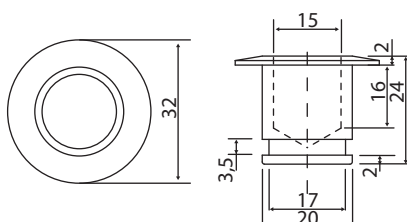

Références / References

Gâche tubulaire pour pêne bas des C600-C602-C600 1/2-C517-C529
Tubular keep bottom bolt for C600-C602-C600 1 / 2-C517-C529



C541.15

C603PG

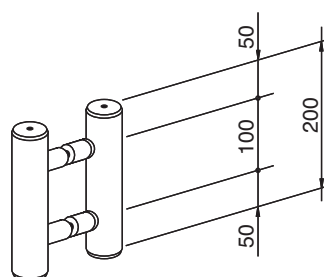

Références / References



Contre-boîtier d'imposte pour C600-C602
Transom patch keep for C600-C602



C603PG.15

Poignées
Handles



Pentures,
serrures et
pièces de fixation
*Locks and
patch fittings*

Pentures 101

Caractéristiques techniques

- Pour verre trempé de 10 mm
- Montage sur encoche 101
- Poids de porte maximum 50 kg
- Dimensions maxi des portes 900 x 2200 mm
- Réversible droite, gauche, haute ou basse pour les séries 3271 et 3275
- Réversible droite, gauche pour les séries 3272 et 3273
- Livré avec joints épaisseur 1 mm
- Pentures basses compatible avec :
 - Pivot frein de sol hydraulique
 - Crapaudine

Technical features

- For 10 mm thick toughened glass
- Assembly on notch 101
- Maximum door weight 50 kg
- Dimensions size of the doors 900 x 2200 mm
- Top or bottom hinge reversible left or right for series 3271 and 3275
- Left or right hinge reversible for series 3271 and 3275
- Supplied with spacers of 1 mm thick
- Bottom hinge compatible with :
 - Hydraulic floor sprin
 - Pivot

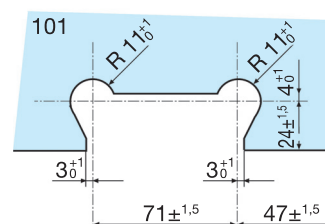
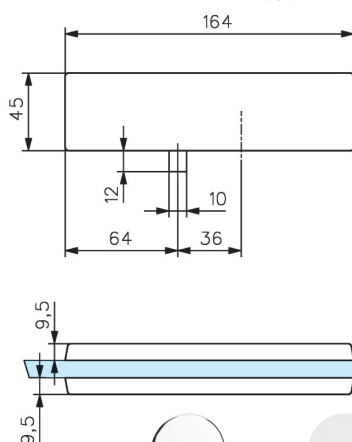







LES + PRODUITS



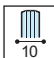



The + product

Réversible
droite, gauche,
haute ou basse
pour 3271 / 3275

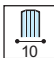
*Top or bottom hinge
reversible left or right
for 3271 and 3275*

Références / References

3271		F					
				Chromé brillant <i>Bright chromium</i>	Chromé mat <i>Matt chromium</i>	Doré <i>Gold plated</i>	Laqué blanc 9010 <i>Lacquered white RAL 9010</i>
Penture réversible haute, basse à enjoliveurs pour axe carré français <i>Top and bottom reversible patch hinge with cover plate, French square recess</i>				3271.30.0	3271.31.0	3271.40.0	3271.51.0

3275		D					
				Chromé brillant <i>Bright chromium</i>	Chromé mat <i>Matt chromium</i>	Doré <i>Gold plated</i>	Laqué blanc 9010 <i>Lacquered white RAL 9010</i>
Penture réversible haute, basse à enjoliveurs pour axe rectangulaire allemand <i>Top and bottom reversible patch hinge with cover plate, German rectangular recess</i>				3275.30.0	3275.31.0	3275.40.0	



3272

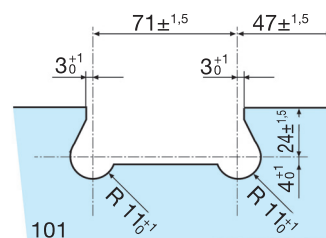
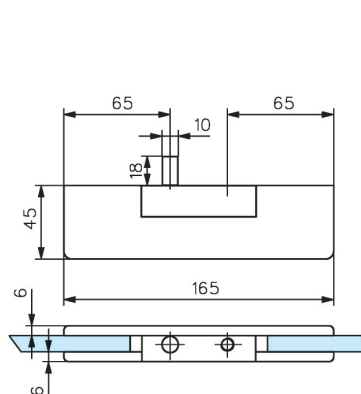

Références / References

				
		Laiton poli <i>Polished brass</i>	Chromé brillant <i>Bright chromium</i>	Chromé mat <i>Matt chromium</i>
Penture massive haute <i>Solid top patch hinge</i>		3272.00.0	3272.30.0	3272.31.0

Pentures, serrures et pièces de fixation
Locks and patch fittings



3273

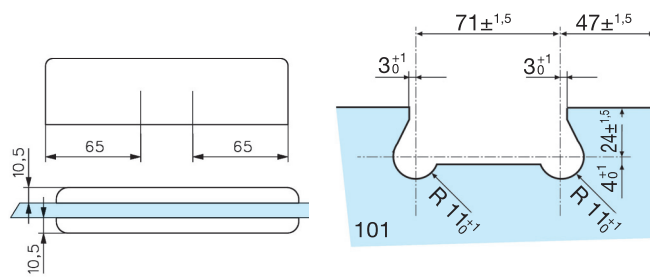

Références / References



Laiton poli
Polished brass



Chromé brillant
Bright chromium



Chromé mat
Matt chromium

Penture massive basse pour axe carré français
Solid bottom patch hinge with French square recess

3273.00.0

3273.30.0

3273.31.0

3280

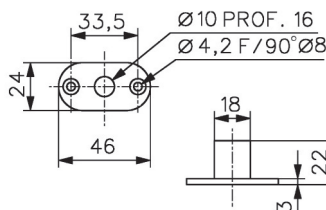

Laiton poli
Polished brass



Chromé brillant
Bright chromium



Chromé mat
Matt chromium

Références / References

Boîte à roulement pour pentures séries 3271, 3272 et 3275
Bearing box for patch hinges series 3271, 3272 and 3275

3280.00.0

3280.30.0

3280.31.0

3281

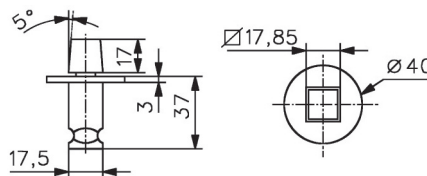

Laiton poli
Polished brass



Chromé brillant
Bright chromium



Chromé mat
Matt chromium

Références / References



Crapaudine à axe carré pour pentures séries 3271 et 3273
Square pin step bearing for patch hinges series 3271 and 3273

3281.00.0

3281.30.0

3281.31.0

Pentures,
serrures et
pièces de fixation
*Locks and
patch fittings*

Serrures basses , boîtier gâche et gâche séries 1358

*Bottom lock, matching patch keep
and keep with guard series 1358*



Caractéristiques techniques

- Pour verre trempé de 10 mm
- Montage sur encoche 61
- Pêne monobloc avec bague anti-sciage
- A cylindre profil européen panneton DIN (norme DIN 18254)
- Livré avec 1 gâche plate et 3 clés

Technical features

- For 10 mm thick toughened glass
- Assembly on notch 61
- One piece bolt with hardened insert
- European profile cylinder (DIN 18254)
- Supplied with flat keep and 3 keys

1358

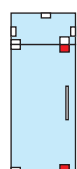
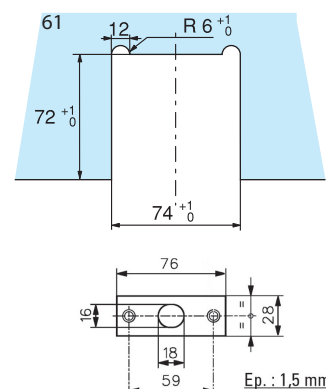
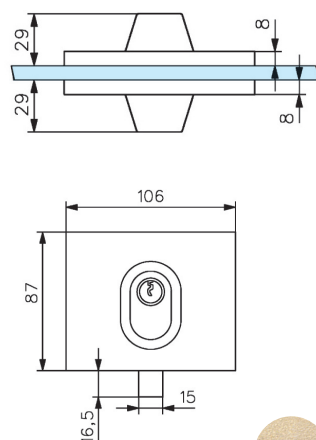

Références / References



Laiton poli
Polished brass



Chromé brillant
Bright chromium



Chromé mat
Matt chromium

Serrure basse avec cylindre à 2 entrées de clé
Bottom lock with euro profile cylinder with 2 key entries

1358.00.0

1358.30.0

1358.31.0

1352

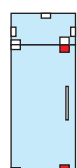
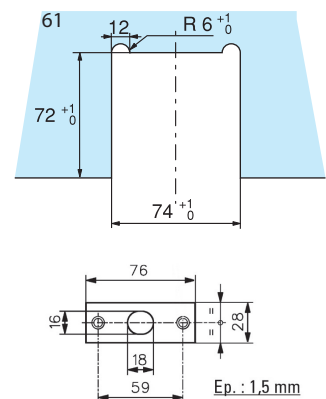
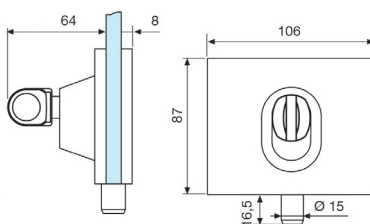

Références / References



Chromé brillant
Bright chromium



Chromé mat
Matt chromium

Serrure basse à bouton d'un seul côté
Bottom lock with knob on one side

1352.30.0

1352.31.0

Pentures,
serrures et
pièces de fixation
*Locks and
patch fittings*

1353

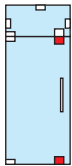
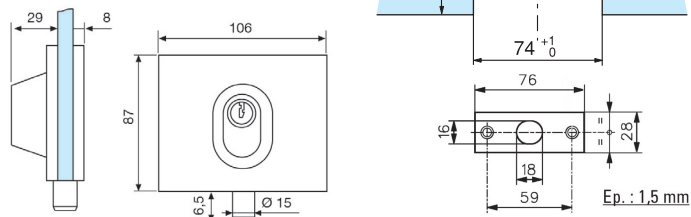

Références / References



Serrure basse à une entrée de clé
Bottom lock with key on one side



Laiton poli
Polished brass



Chromé brillant
Bright chromium



Chromé mat
Matt chromium

1353.00.0

1353.30.0

1353.31.0

1357

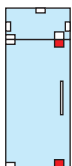
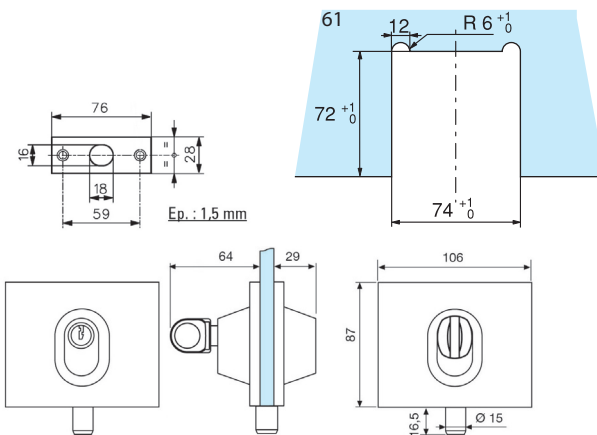

Références / References



Serrure basse à clé et à bouton
Bottom lock with key and knob



Chromé brillant
Bright chromium



Chromé mat
Matt chromium

1357.30.0

1357.31.0

1359

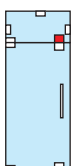
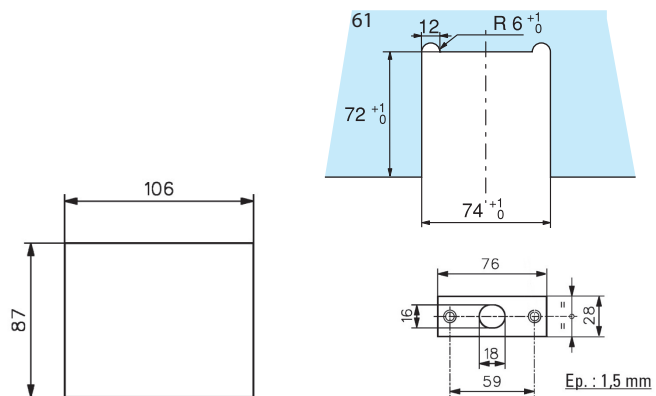

Références / References



Boîtier gâche pour serrures 1352, 1353, 1357 et 1358
Matching patch keep for lock 1352, 1353, 1357 and 1358



Laiton poli
Polished brass



Chromé brillant
Bright chromium



Chromé mat
Matt chromium

1359.00.0

1359.30.0

1359.31.0

Pentures,
serrures et
pièces de fixation
*Locks and
patch fittings*

9953

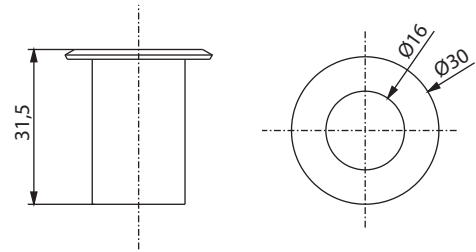

Chromé brillant
Bright chromium



Chromé mat
Matt chromium

Références / References

Gâche tubulaire pour serrures série 1358
Tubular keep for series 1358

9953.30.0

9953.31.0



9954

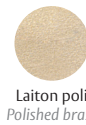
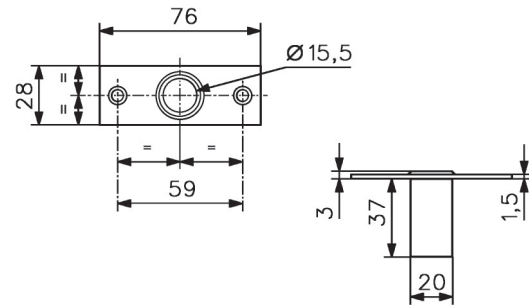

Laiton poli
Polished brass



Chromé mat
Matt chromium

Références / References

Gâche anti-poussière à obturateur avec platine à 2 trous de fixation,
pour serrures série 1358
Keep with anti-dust guard, two fixing holes for locks series 1358

9954.00.0

9954.31.0

9954.**.3

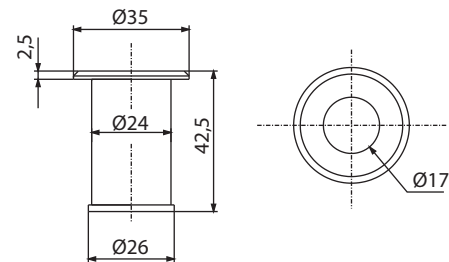

Laiton poli
Polished brass



Chromé mat
Matt chromium

Références / References

Gâche anti-poussière à obturateur avec platine cylindrique à visser
pour serrures série 1358
Keep with anti-dust guard for locks series 1358

9954.00.3

9954.31.3

Verrou cavalier à demi-cylindre 1435 et 1436

Clip on lock with half euro profile cylinder 1435 and 1436

Pentures,
serrures et
pièces de fixation
Locks and
patch fittings

Caractéristiques techniques

- Montage sans encoche
- Se pose en cavalier sur la porte, jeu minimum 4 mm
- Fixation par 2 vis de serrage pour 1435 et 1439
- Permet d'obtenir un 2ème point de condamnation avec une serrure basse série 1358
- Possibilités de combinaison avec passe général sauf 1436
- Livré avec 1 gâche plate et 3 clés

Technical features

- No notches required
- Fixing on edge of door, minimum space 4 mm
- Fixing with 2 screws for series 1435 and 1439
- To match bottom lock series 1358 to provide 2 locking points
- Possibility of combinations with master key except 1436
- Supplied with flat keep and 3 keys

1435

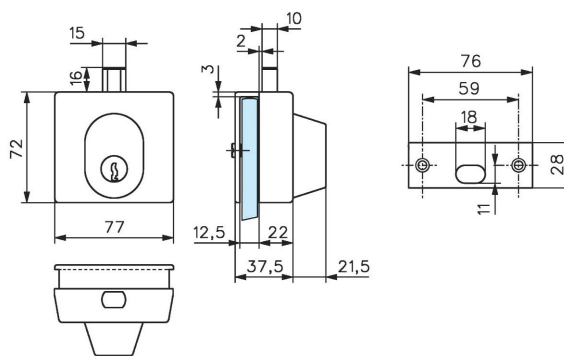

Références / References



Chromé brillant
Bright chromium



Chromé mat
Matt chromium



Doré
Gold plated

Verrou cavalier à demi-cylindre profil européen panneton DIN
Clip on lock with half euro profile cylinder

1435.30.0

1435.31.0

1435.40.0

1439

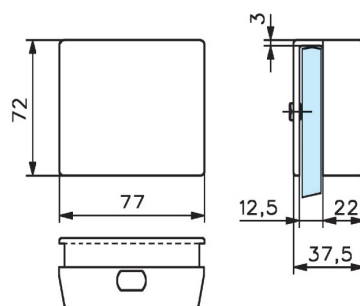

Références / References



Chromé brillant
Bright chromium



Chromé mat
Matt chromium



Doré
Gold plated

Boîtier gâche pour verrou cavalier 1435
Matching patch keep to fit with series 1435

1439.30.0

1439.31.0

1439.40.0

Pentures,
serrures et
pièces de fixation
*Locks and
patch fittings*

S171..3**



Laiton poli
Polished brass

S171.00.3



Inox Brossé
Brushed stainless steel

S171.15.3



Inox poli
Polished stainless steel

S171.16.3

100 vis pour pentures séries 3272 et 3273
100 screws for patch hinge series 3272 and 3273



S229.99.4



100 joints épaisseur 1 mm pour pentures séries 3272 et 3273
100 spacers 1 mm thickness for patch hinge series 3272 and 3273

S229.99.6



100 joints épaisseur 1,5 mm pour pentures séries 3271 et 3275
100 spacers 1,5 mm thickness for patch hinge series 3271 and 3275

Pentures,
serrures et
pièces de fixation
*Locks and
patch fittings*



Pentures,
serrures et
pièces de fixation
*Locks and
patch fittings*

ELITE



Caractéristiques techniques

- Dimensions 52x165 mm (pièces standard V500, V501, V511, V514)
- Pour verre de 8, 10 et 12 mm ou 15 ou 19 mm
- Montage sur encoche V500E (pièces standard V500, V501, V511, V514)
- Poids maximum 100 kg
- Dimensions maxi. des portes 1250 x 2350 mm ou 1000 x 2450 mm

Pour verre épaisseur 8 et 12 mm :
Commander des intercalaires complémentaires.

Technical features

- Dimensions 52x165 mm (standard fittings V500, V501, V511, V514)
- For 8, 10 and 12mm or for 15 or 19 mm thick glass
- Assembly on notch V500E (standard fittings V500, V501, V511, V514)
- Maximum door weight 100 kg
- Maximum size for glass doors 1250 x 2350 mm or 1000 x 2450 mm

For 8 and 12 mm thick glass :
Please order additional spacers

LES + PRODUITS

The + product

Grande qualité
de finition

Gamme complète

Réversibles

High quality finishes

Full range

Reversible



INSTALLATION STANDARD

STANDARD INSTALLATION

Pentures, serrures et pièces de fixation
Locks and patch fittings

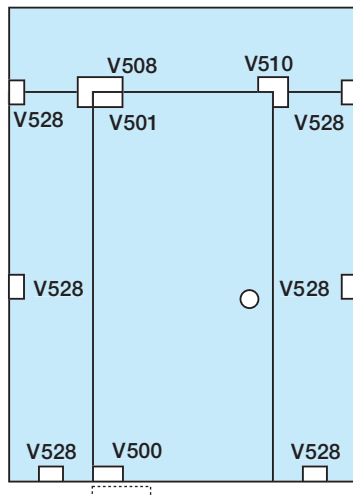
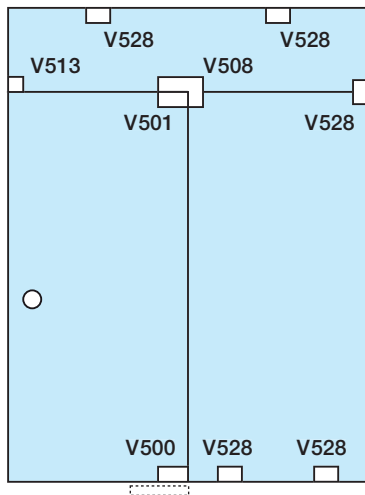
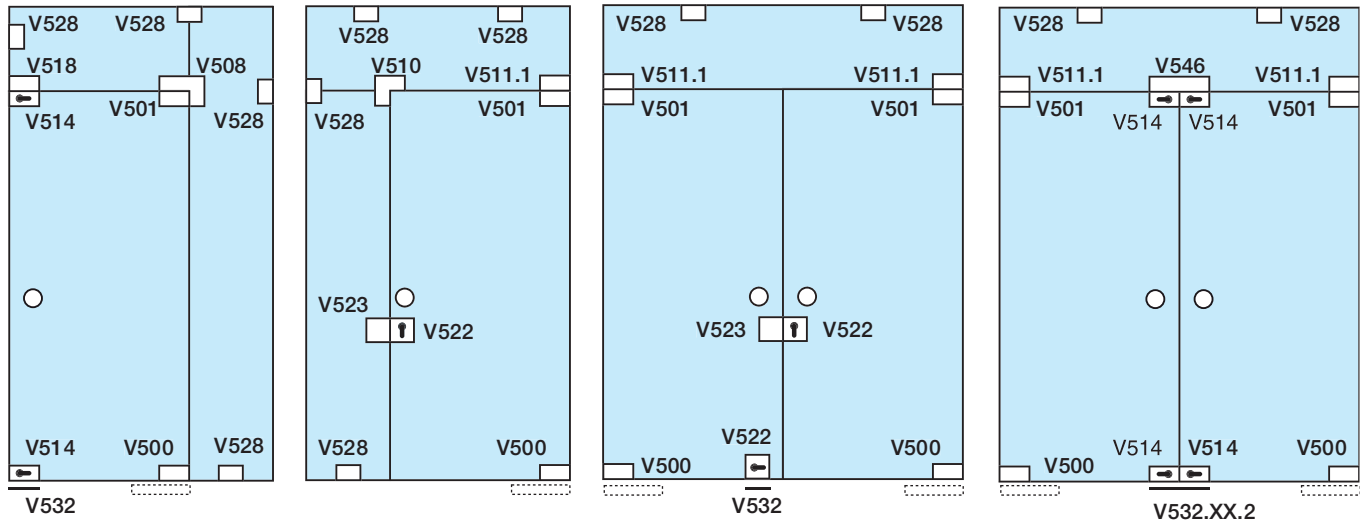

KL001, KL002

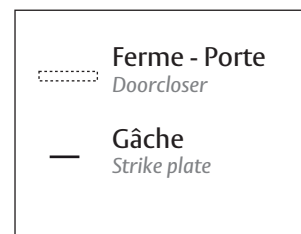
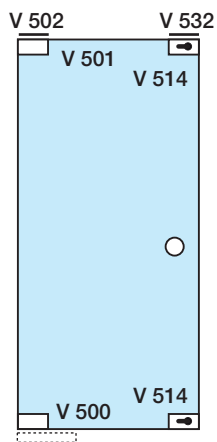
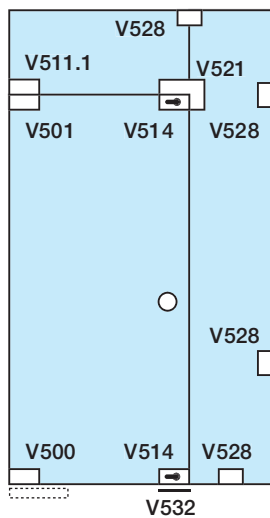
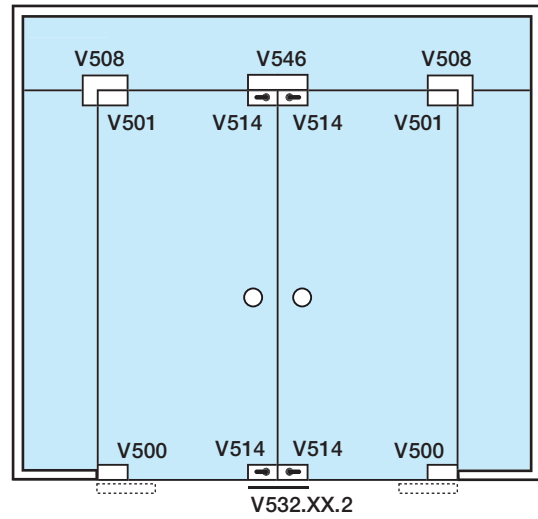

Pentures,
serrures et
pièces de fixation
*Locks and
patch fittings*

JEUX RECOMMANDÉS

RECOMMENDED TOLERANCES

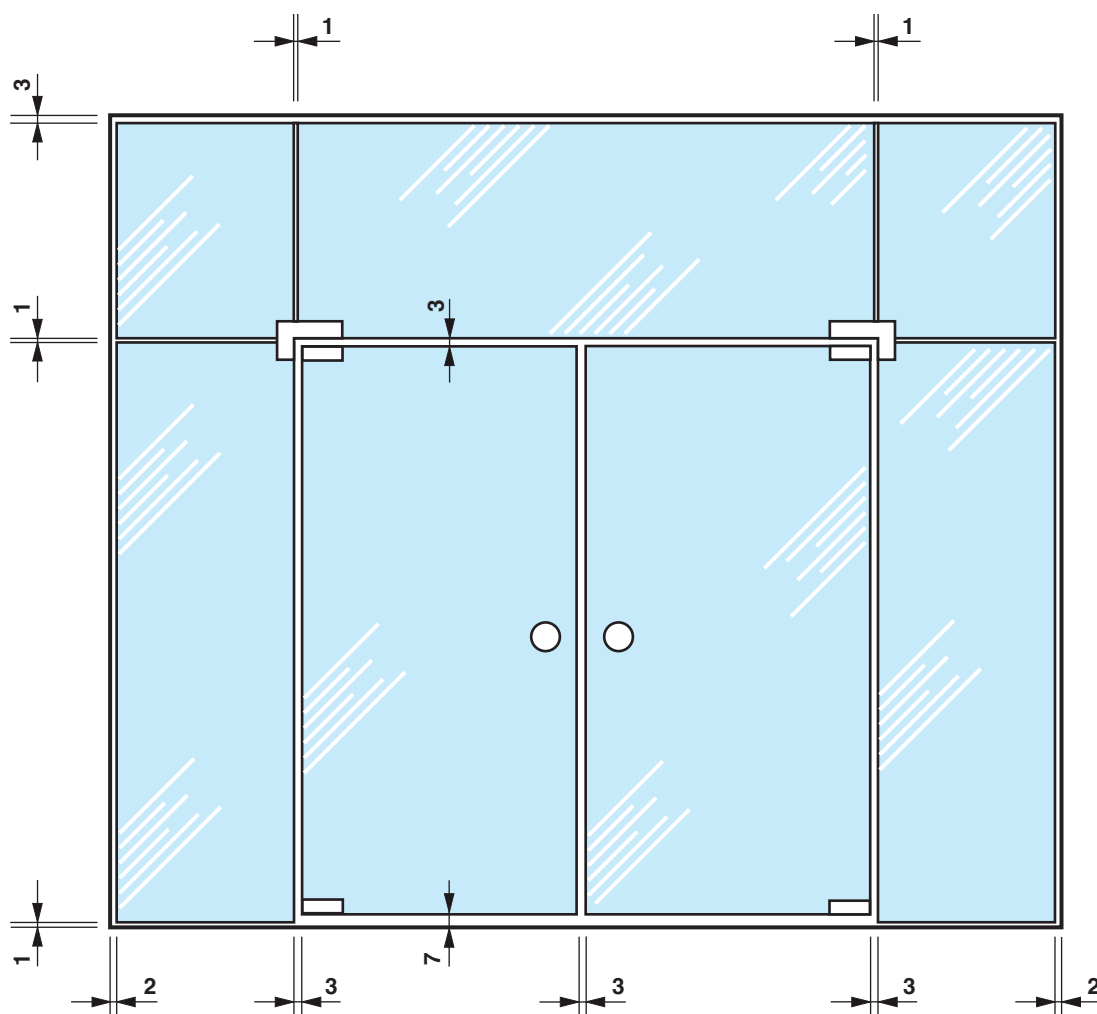

V502

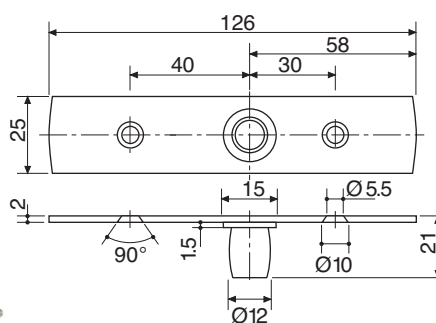

Références / References

Pivot supérieur pour V501/V201
Top pivot for V501/V201

Inox Brossé
Brushed stainless steel

V502.15

V502.3.33



Références / References



Pivot supérieur pour V501/V201
Top pivot for V501/V201

Pentures,
serrures et
pièces de fixation
*Locks and
patch fittings*

V501

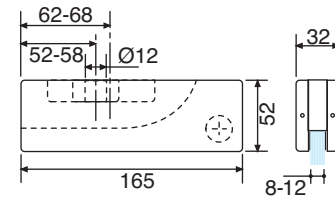
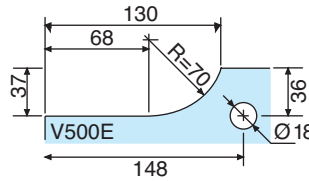
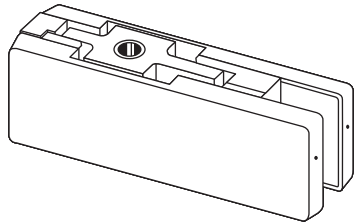

Références / References



Penture haute (Montage sur encoche V500E)
Top patch fitting (Assembly on notch V500E)

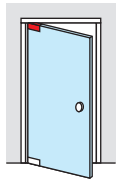

V501.01



V501.12



V501.15



V501.30

V201

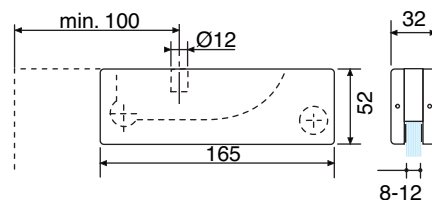
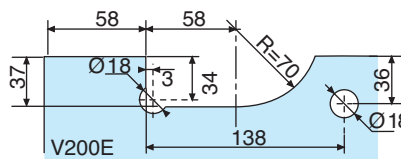
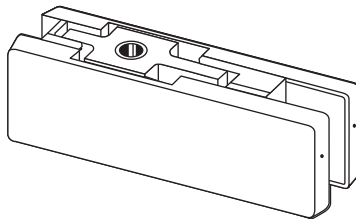

Références / References



Penture haute à rotation axiale déportée (Montage sur encoche V200E)
Top patch fitting with variable pivot point (Assembly on notch V200E)

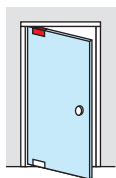

V201.12



V201.15



V201.30

Pentures,
serrures et
pièces de fixation
*Locks and
patch fittings*

V500F

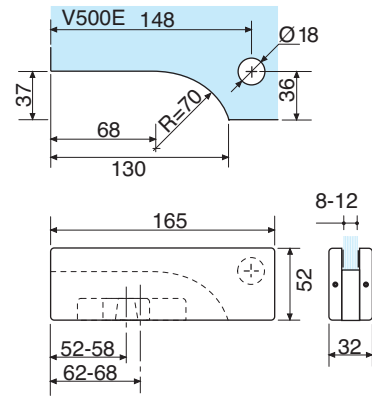
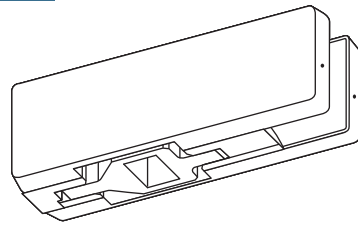

Références / References



Penture basse pour axe carré français (Montage sur encoche V500E)
Bottom patch fitting French square spindle (Assembly on notch V500E)

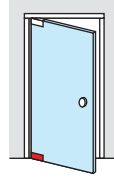

Laiton poli verni <i>Polished varnished brass</i>	Aluminium anodisé Argent Brossé <i>Brushed anodised alu. silver</i>	Inox Brossé <i>Brushed stainless steel</i>	Chromé brillant <i>Bright chromium</i>
V500F.01	V500F.12	V500F.15	V500F.30



V500D

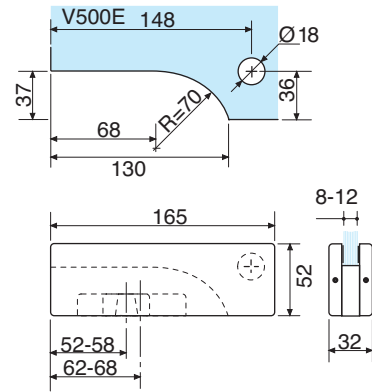
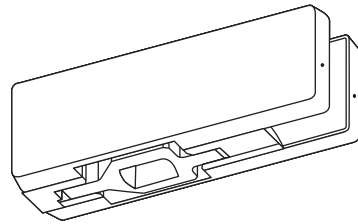

Références / References



Penture basse pour axe rectangulaire allemand (Montage sur encoche V500E)
Bottom patch fitting German rectangular spindle (Assembly on notch V500E)

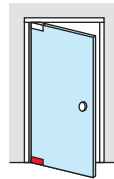

Laiton poli verni <i>Polished varnished brass</i>	Aluminium anodisé Argent Brossé <i>Brushed anodised alu. silver</i>	Inox Brossé <i>Brushed stainless steel</i>	Chromé brillant <i>Bright chromium</i>
V500D.01	V500D.12	V500D.15	V500D.30

V200D

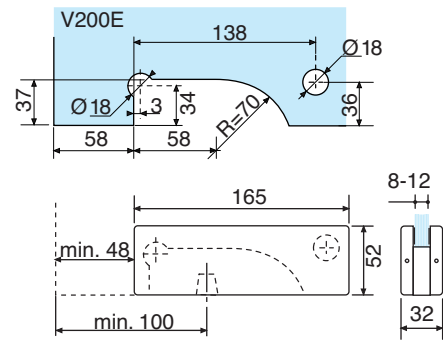
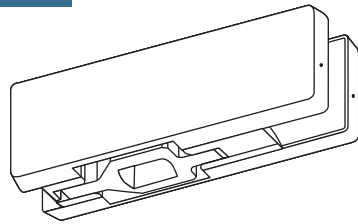

Références / References



Penture basse pour axe rectangulaire allemand à rotation axiale déportée (Montage sur encoche V200E)
Bottom patch fitting German rectangular spindle with variable pivot point (Assembly on notch V200E)

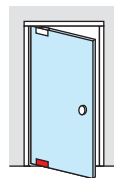

Laiton poli verni <i>Polished varnished brass</i>	Aluminium anodisé Argent Brossé <i>Brushed anodised alu. silver</i>	Inox Brossé <i>Brushed stainless steel</i>	Chromé brillant <i>Bright chromium</i>
V200D.01	V200D.12	V200D.15	V200D.30

V550D

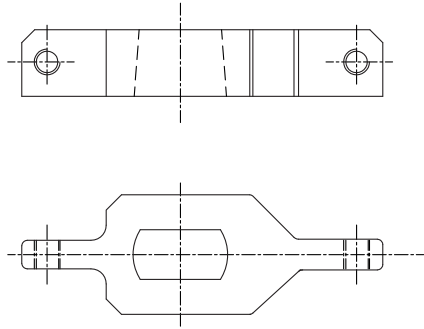

Références / References

D

Insert rectangulaire allemand pour V500 et V200
German rectangular insert for V500 and V200

V550F

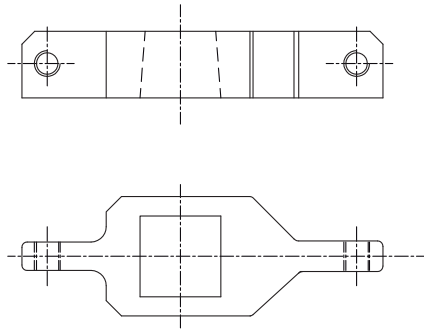

Références / References

F

Insert rectangulaire allemand pour V500 et V200
German rectangular insert for V500 and V200

V550I

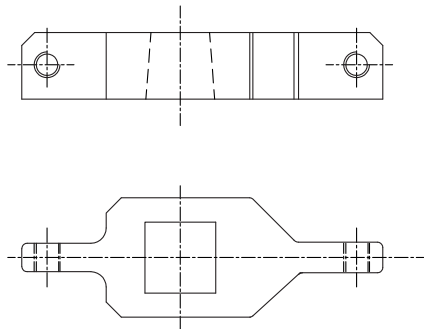

Références / References

I

Insert rectangulaire allemand pour V500 et V200
German rectangular insert for V500 and V200

Pentures,
serrures et
pièces de fixation
*Locks and
patch fittings*

V535

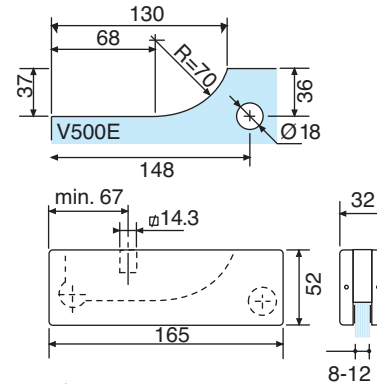
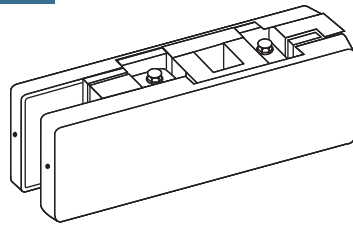

Références / References



Penture haute pour ferme porte 5600/5750 (Montage sur encoche V500E)
Top patch fitting for door closer 5600/5750 (Assembly on notch V500E)

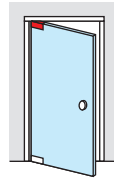

- | | | | |
|---|---|--|------------------------------------|
| | | | |
| Laiton poli verni
Polished varnished brass | Aluminium anodisé Argent Brossé
Brushed anodised alu. silver | Inox Brossé
Brushed stainless steel | Chromé brillant
Bright chromium |
| V535.01 | V535.12 | V535.15 | V535.30 |



V235

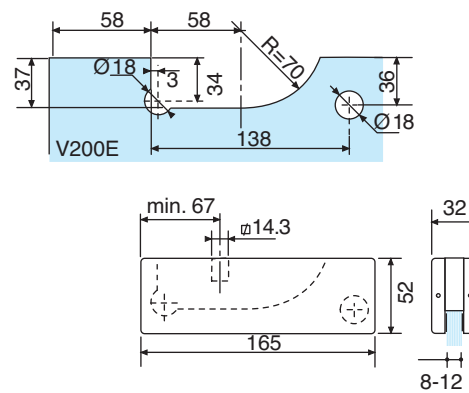
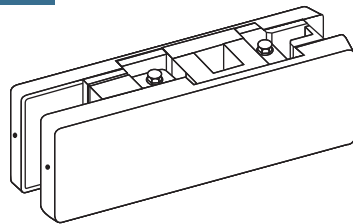

Références / References



Penture haute pour ferme porte 5600/5750 rotation axiale déportée (Montage sur encoche V200E)
Top patch fitting for door closer 5600/5750 with variable pivot point (To fit notch V200E)

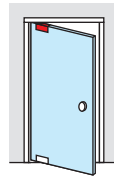

- | | | | |
|---|---|--|------------------------------------|
| | | | |
| Laiton poli verni
Polished varnished brass | Aluminium anodisé Argent Brossé
Brushed anodised alu. silver | Inox Brossé
Brushed stainless steel | Chromé brillant
Bright chromium |
| V235.01 | V235.12 | V235.15 | V235.30 |

V536

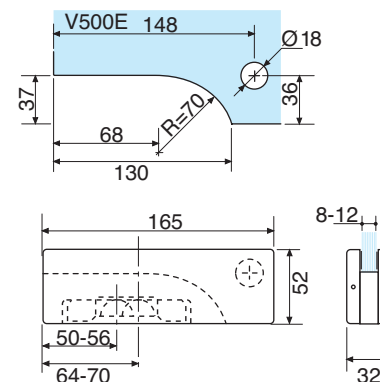
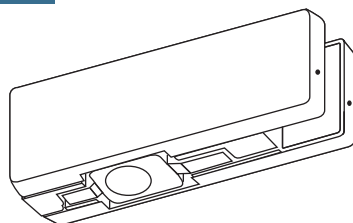

Références / References



Penture basse avec insert dome pour AC311 (Montage sur encoche V500E)
Bottom patch fitting with dome insert for AC311 (Assembly on notch V500E)

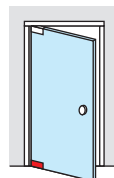

- | | | | |
|---|---|--|------------------------------------|
| | | | |
| Laiton poli verni
Polished varnished brass | Aluminium anodisé Argent Brossé
Brushed anodised alu. silver | Inox Brossé
Brushed stainless steel | Chromé brillant
Bright chromium |
| V536.01 | V536.12 | V536.15 | V536.30 |

V236

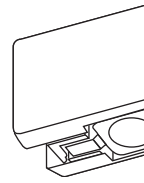
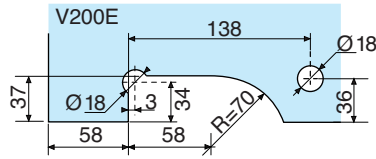
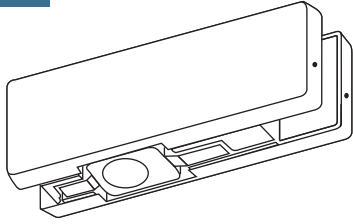

Références / References



Penture basse avec insert dome pour AC311 rotation axiale déportée (Montage sur encoche V200E)
 Bottom patch fitting with dome insert for AC311 with variable pivot point (Assembly on notch V200E)

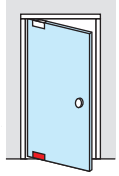

Laiton poli verni Polished varnished brass	Aluminium anodisé Argent Brossé Brushed anodised alu. silver	Inox Brossé Brushed stainless steel	Chromé brillant Bright chromium
V236.01	V236.12	V236.15	V236.30

AC311.15

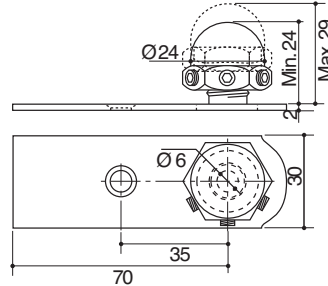

Faux pivot dome réglable pour V536
 Dome floor pivot for V536

AC246.33

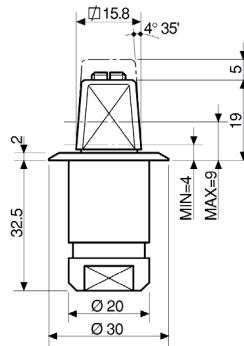

Crapaudine à sceller axe carré italien
 Adjustable Italian square free swing floor pivot

AC299.33

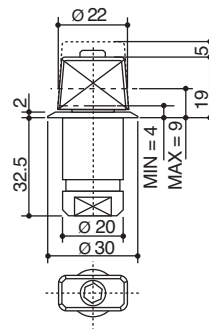

Crapaudine à sceller axe rectangulaire allemand
 Adjustable German rectangular free swing floor pivot

Pentures,
 serrures et
 pièces de fixation
*Locks and
 patch fittings*

Pentures,
serrures et
pièces de fixation
*Patch fittings
and locks*

V511.1

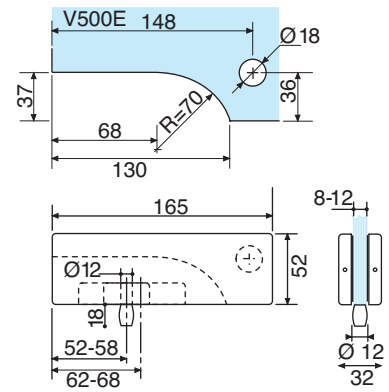
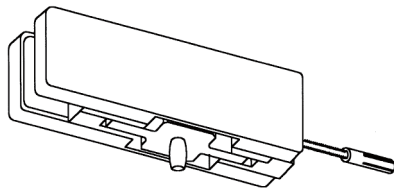

Références / References



Contre-sabot d'imposte avec tige filetée et cheville (Montage sur encoche V500E)

Side fixed transom panel patch with pivot for double acting doors with rod and plug (Assembly on notch V500E)

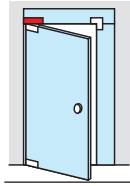

Laiton poli verni Polished varnished brass	Aluminium anodisé Argent Brossé Brushed anodised alu. silver	Inox Brossé Brushed stainless steel	Chromé brillant Bright chromium
V511.1.01	V511.1.12	V511.1.15	V511.1.30



V211

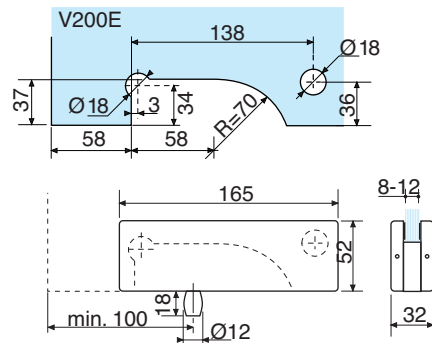
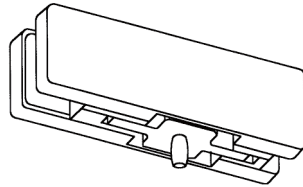

Références / References



Contre-sabot d'imposte à rotation axiale déplacée (Montage sur encoche V200E)

Transom panel patch with off-centre pivot (Assembly on notch V200E)

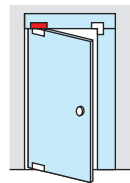

Laiton poli verni Polished varnished brass	Aluminium anodisé Argent Brossé Brushed anodised alu. silver	Inox Brossé Brushed stainless steel	Chromé brillant Bright chromium
V211.01	V211.12	V211.15	V211.30

Pentures,
serrures et
pièces de fixation
*Locks and
patch fittings*

V513

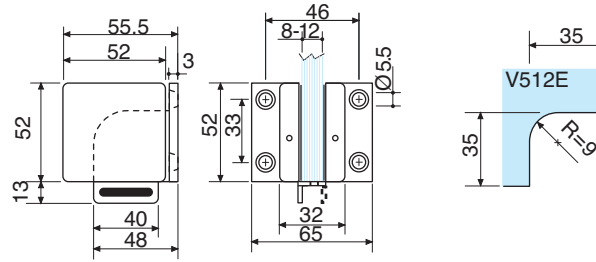
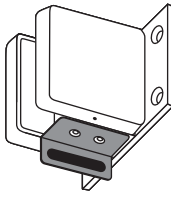

Références / References



Pièce d'angle d'imposte avec plaque murale et avec butée réversible amovible (Montage sur encoche V512E)
Side fixed transom panel patch with wall plate and removable reversible stop (Assembly on notch V512E)

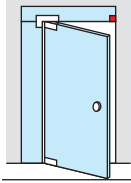

Laiton poli verni <i>Polished varnished brass</i>	Aluminium anodisé Argent Brossé <i>Brushed anodised alu. silver</i>	Inox Brossé <i>Brushed stainless steel</i>	Chromé brillant <i>Bright chromium</i>
V513.01	V513.12	V513.15	V513.30

V582

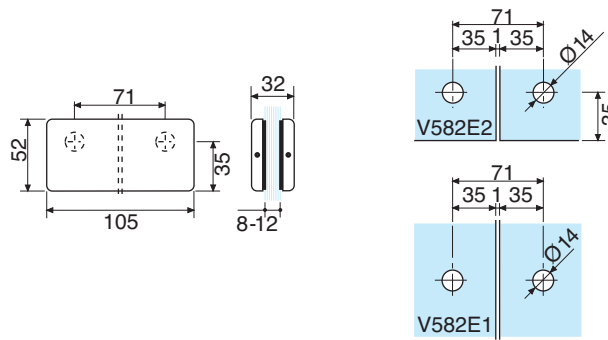
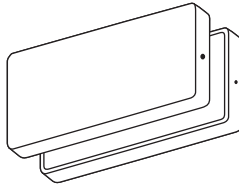

Références / References

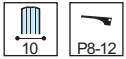

Liaison pour 2 panneaux fixes (Montage sur encoche V582E1-V582E2)
Fixed panel connector for 2 fixed panels (Assembly on notch V582E1-V582E2)

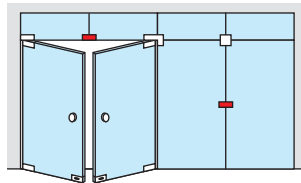

Laiton poli verni <i>Polished varnished brass</i>	Aluminium anodisé Argent Brossé <i>Brushed anodised alu. silver</i>	Inox Brossé <i>Brushed stainless steel</i>	Chromé brillant <i>Bright chromium</i>
V582.01	V582.12	V582.15	V582.30

V528

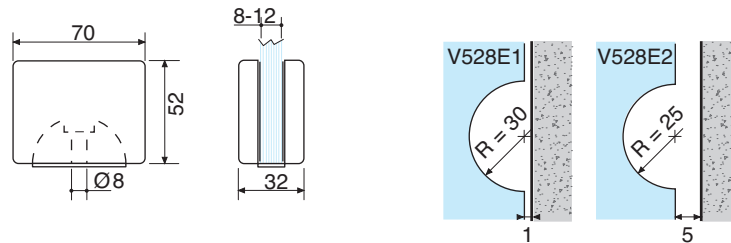
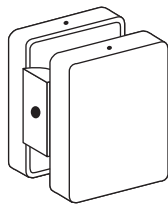

Références / References

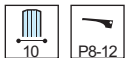

Pièce de fixation murale pour glaces fixes à vis (Montage sur encoche V528E1-V528E2)
Wall to glass patch for fixed panel to screw on (Assembly on notch V528E1-V528E2)

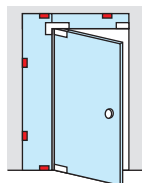

Laiton poli verni <i>Polished varnished brass</i>	Aluminium anodisé Argent Brossé <i>Brushed anodised alu. silver</i>	Inox Brossé <i>Brushed stainless steel</i>	Chromé brillant <i>Bright chromium</i>
V528.01	V528.12	V528.15	V528.30

Pentures,
serrures et
pièces de fixation
*Locks and
patch fittings*

V581

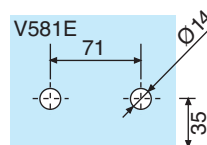
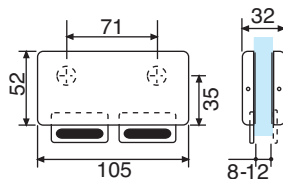
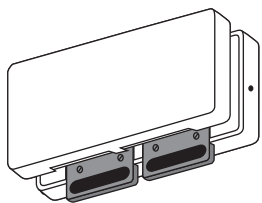

Références / References

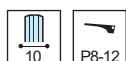

Pièce de liaison pour 2 glaces fixes avec double butée réversible (Montage sur encoche V581E)
Fixed panel connector for two fixed panels with reversible stop (Assembly on notch V581E)

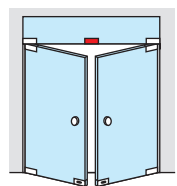

Laiton poli verni <i>Polished varnished brass</i>	Aluminium anodisé Argent Brossé <i>Brushed anodised alu. silver</i>	Inox Brossé <i>Brushed stainless steel</i>	Chromé brillant <i>Bright chromium</i>
V581.01	V581.12	V581.15	V581.30

V514

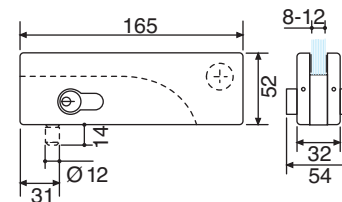
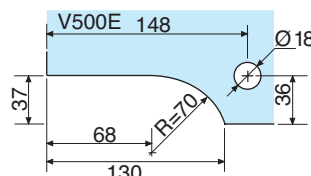
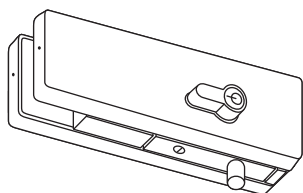

Références / References

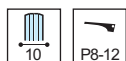

Serrure d'angle avec cylindre Européen (Montage sur encoche V500E)
Corner lock with Euro profile cylinder (Assembly on notch V500E)

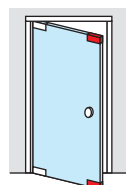

Laiton poli verni <i>Polished varnished brass</i>	Aluminium anodisé Argent Brossé <i>Brushed anodised alu. silver</i>	Inox Brossé <i>Brushed stainless steel</i>	Chromé brillant <i>Bright chromium</i>
V514.01	V514.12	V514.15	V514.30

V519.1

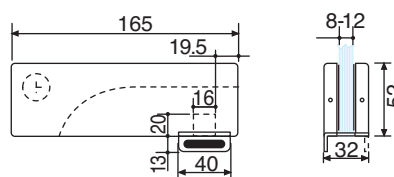
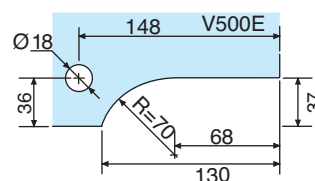
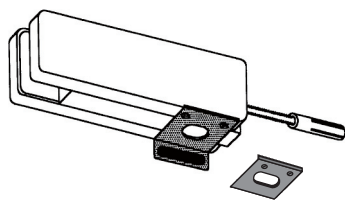

Références / References

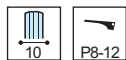

Contre-boîtier pour serrure de coin avec ou sans butée réversible et tige filetée (Montage sur encoche V500E)
Side fixed transom panel patch for corner lock with or without reversible stop, rod and plug (Assembly on notch V500E)

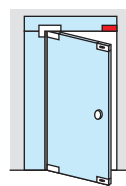

Laiton poli verni <i>Polished varnished brass</i>	Aluminium anodisé Argent Brossé <i>Brushed anodised alu. silver</i>	Inox Brossé <i>Brushed stainless steel</i>	Chromé brillant <i>Bright chromium</i>
V519.1.01	V519.1.12	V519.1.15	V519.1.30

Pentures,
serrures et
pièces de fixation
*Locks and
patch fittings*



Pentures,
serrures et
pièces de fixation
*Locks and
patch fittings*



V546

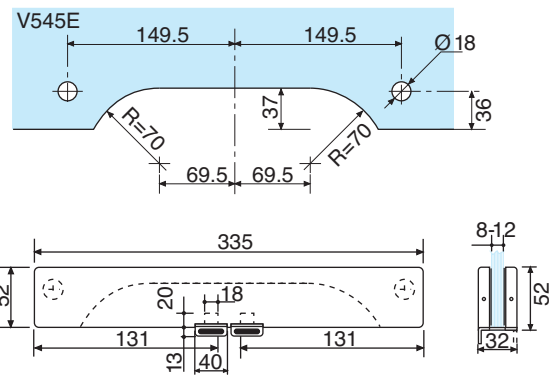
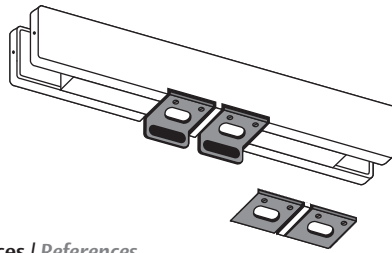

Références / References

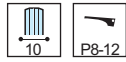

Double contre-boîtier pour serrure d'angle avec ou sans butée réversible (Montage sur encoche V500E)
Double transom panel patch for corner lock with or without reversible stop (Assembly on notch V500E)

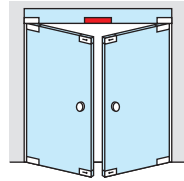

Laiton poli verni Polished varnished brass	Aluminium anodisé Argent Brossé Brushed anodised alu. silver	Inox Brossé Brushed stainless steel	Chromé brillant Bright chromium
V546.01	V546.12	V546.15	V546.30

V522

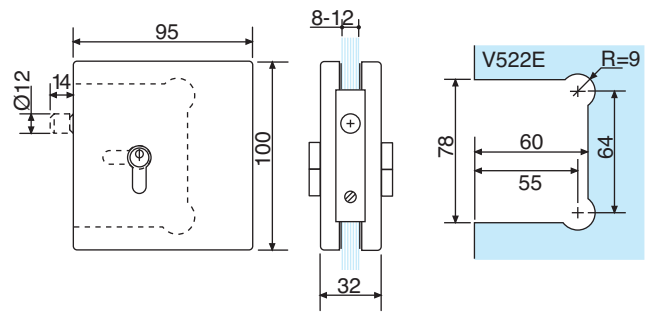
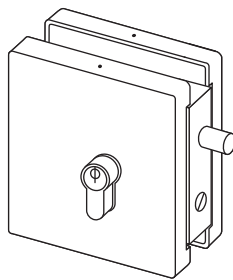

Références / References

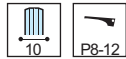

Serrure universelle à pêne dormant avec cylindre Européen (Montage sur encoche V522E)
Reversible lock with Euro profile cylinder (Assembly on notch V522E)

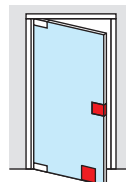

Laiton poli verni Polished varnished brass	Aluminium anodisé Argent Brossé Brushed anodised alu. silver	Inox Brossé Brushed stainless steel	Chromé brillant Bright chromium
V522.01	V522.12	V522.15	V522.30

V523

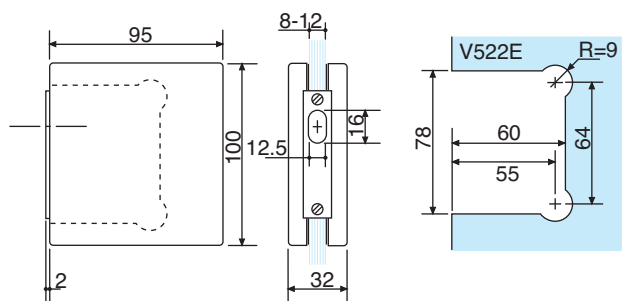
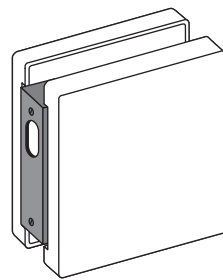

Références / References

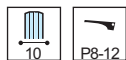

Contre-boîtier pour V522 (Montage sur encoche V522E)
Patch keep for V522 (Assembly on notch V522E)

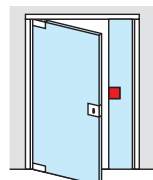

Laiton poli verni Polished varnished brass	Aluminium anodisé Argent Brossé Brushed anodised alu. silver	Inox Brossé Brushed stainless steel	Chromé brillant Bright chromium
V523.01	V523.12	V523.15	V523.30

V542.2

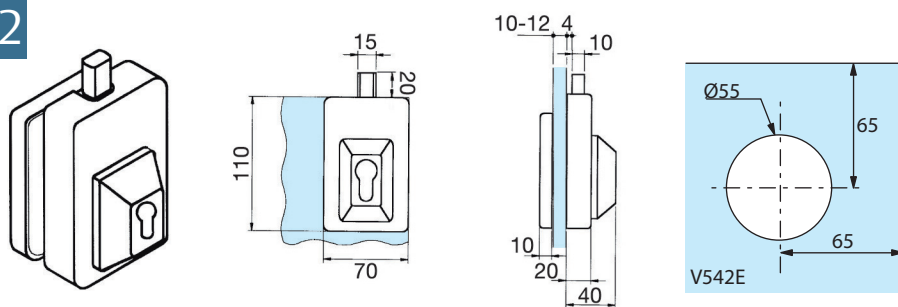

Références / References



Serrure d'angle réversible pour cylindre Européen (Montage sur encoche V542E)
 Reversible corner lock with Euro profile cylinder and security rosettes (Assembly on notch V542E)

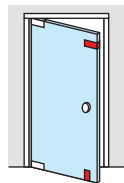

Aluminium anodisé Argent Brossé Brushed anodised alu. silver	Inox Brossé Brushed stainless steel	Chromé brillant Bright chromium
V542.2.12	V542.2.15	V542.2.30

V515

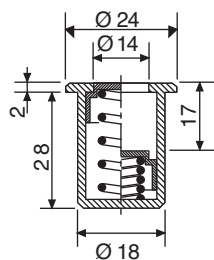

Références / References



Chromé mat brossé
Brushed matt chromium

Gâche anti-poussière pour V514 - V522 - V542.2
 Tubular dustproof bolt keep for V514 - V522 - V542.2

V515.33

V532

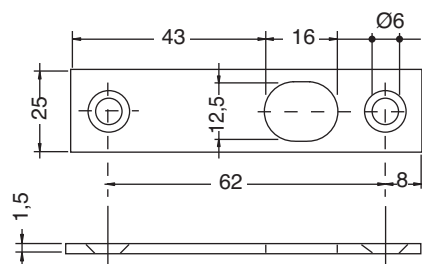

Références / References



Inox Brossé
Brushed stainless steel

Gâche pour V514 - V522 - V542.2 - C222
 Flat keep for V514 - V522 - V542.2 - C222

V532.15

V532.2

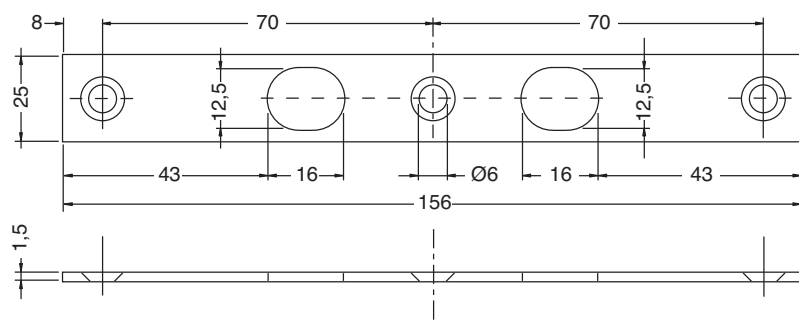

Références / References



Inox Brossé
Brushed stainless steel

Gâche pour 2 serrures de coin V514
 Flat keep for 2 corner locks V514

V532.2.15

Pentures,
serrures et
pièces de fixation
Locks and
patch fittings

Pentures,
serrures et
pièces de fixation
*Locks and
patch fittings*

V510

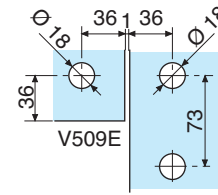
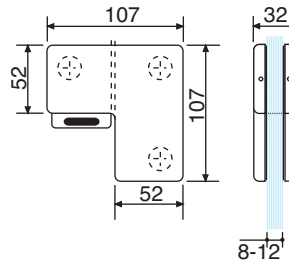
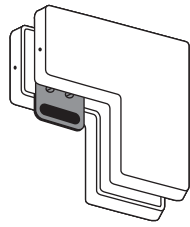

Références / References

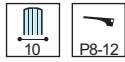

Pièce de liaison imposte et glace fixe avec butée réversible (Montage sur encoche V509E)
Transom and side panel link patch with reversible stop (Assembly on notch V509E)

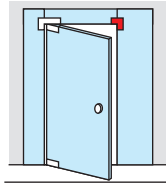

Laiton poli verni <i>Polished varnished brass</i>	Aluminium anodisé Argent Brossé <i>Brushed anodised alu. silver</i>	Inox Brossé <i>Brushed stainless steel</i>	Chromé brillant <i>Bright chromium</i>
V510.01	V510.12	V510.15	V510.30



V508

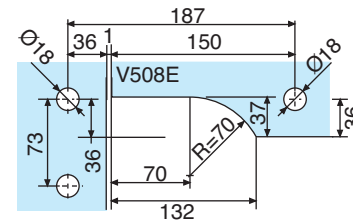
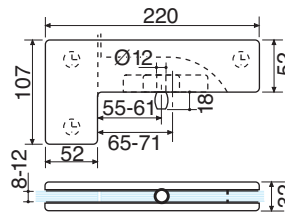
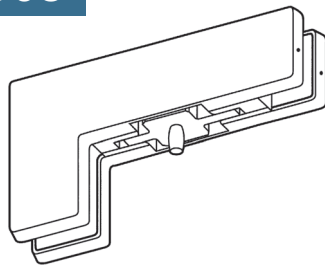

Références / References

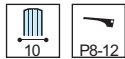

Pièce de liaison imposte et glace fixe avec pivot (Montage sur encoche V508E)
Transom and side panel link patch with pivot (Assembly on notch V508E)

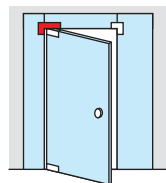

Laiton poli verni <i>Polished varnished brass</i>	Aluminium anodisé Argent Brossé <i>Brushed anodised alu. silver</i>	Inox Brossé <i>Brushed stainless steel</i>	Chromé brillant <i>Bright chromium</i>
V508.01	V508.12	V508.15	V508.30



Pentures,
serrures et
pièces de fixation
*Locks and
patch fittings*

V521

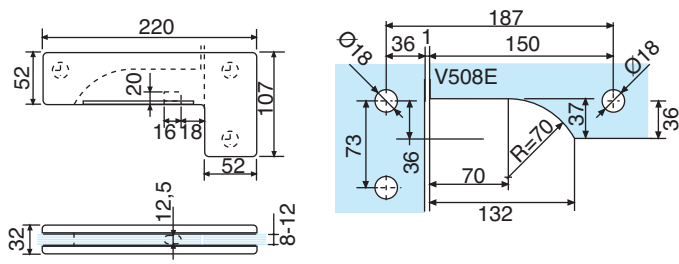
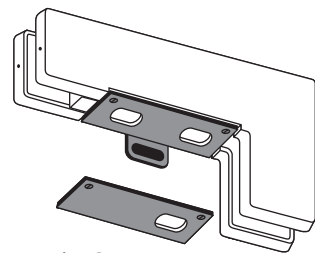

Références / References

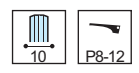

Pièce de liaison imposte et glace fixe, contre-boîtier avec ou sans butée réversible pour serrure V514 (Montage sur encoche V508E)
Transom and side panel link patch with strike with or without reversible stop for lock V514 (Assembly on notch V508E)

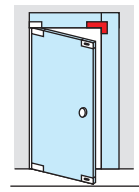

V521.01 V521.12 V521.15 V521.30



V564

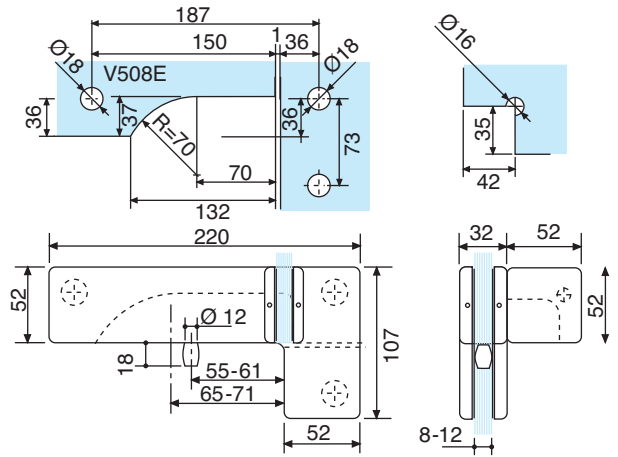
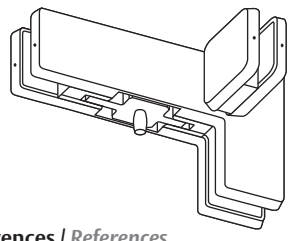

Références / References

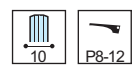

Pièce de liaison imposte et glace fixe avec pivot et ailette de contreventement (Montage sur encoche V508E + V512E1)
Transom and side panel link patch with pivot and fin link holder (Assembly on notch V508E + V512E1)

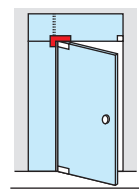

V564.12 V564.15

V565

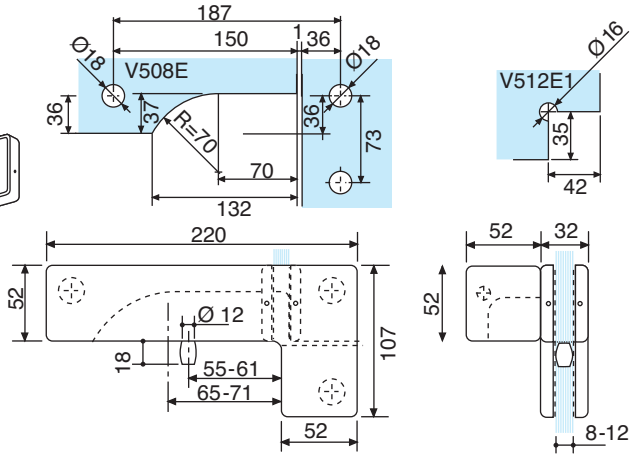
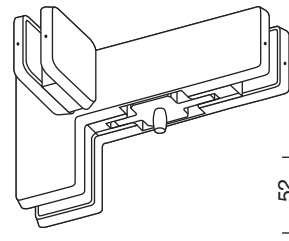

Références / References

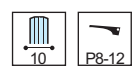

Pièce de liaison imposte et glace fixe avec pivot et ailette de contreventement (Montage sur encoche V508E + V512E)
Transom and side panel link patch with pivot and fin link holder (Assembly on notch V508E + V512E)

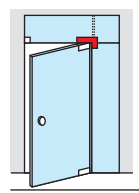

V565.12 V565.15



Serrures anti-paniques
Anti-panic locks

ASSA ABLOY

Serrures anti-paniques
Anti-panic locks



LES + PRODUITS

The + product

Adaptée pour porte en verre
Esthétique

Adapted to glass doors
Aesthetic

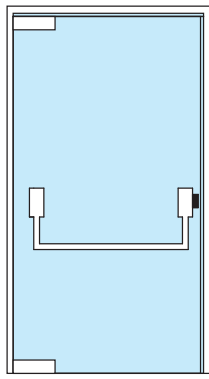

Porte A / Door A

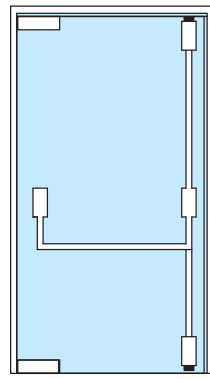

Porte B / Door B

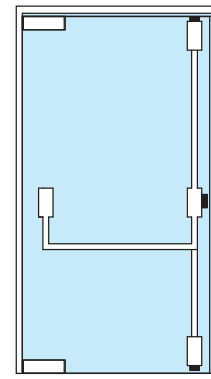

Porte C / Door C

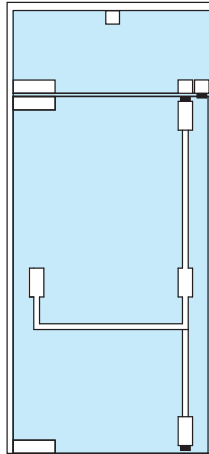

Porte D / Door D

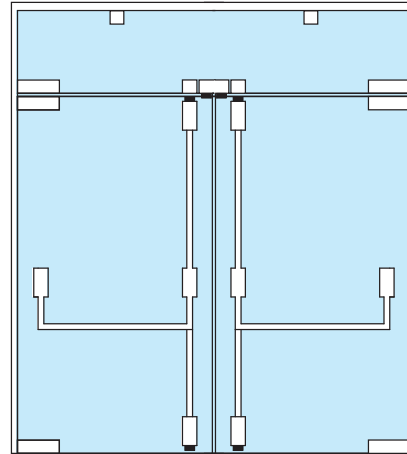

Porte E / Door E

ARTICLES NÉCESSAIRES / REFERENCES NEEDED

Type de condamnation Closing Type	M1040 + V586 Encoche N°1 Notch N°1	AO22330 + V587 Encoche N°2 Notch N°2	V588 Encoche N°6 Notch N°6	AO41730 Poignée Ext. Ext. Handle
Porte A / Door A	1			1
Porte B / Door B	1	1		1
Porte C / Door C	1	1		1
Porte D / Door D	1	1	1	1
Porte E / Door E	2	2	2	2

M1040 + V586

Serrures anti-paniques
Anti-panic locks

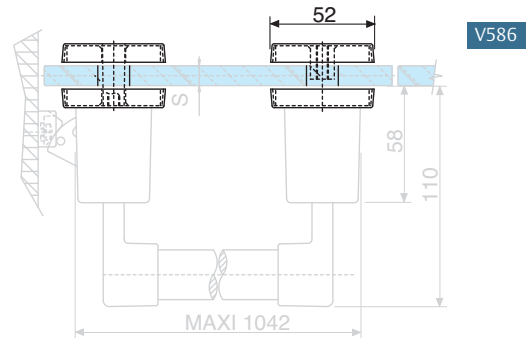
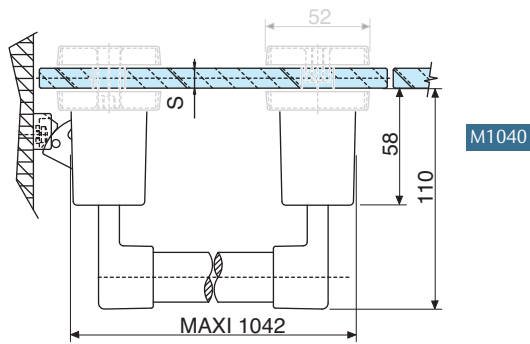
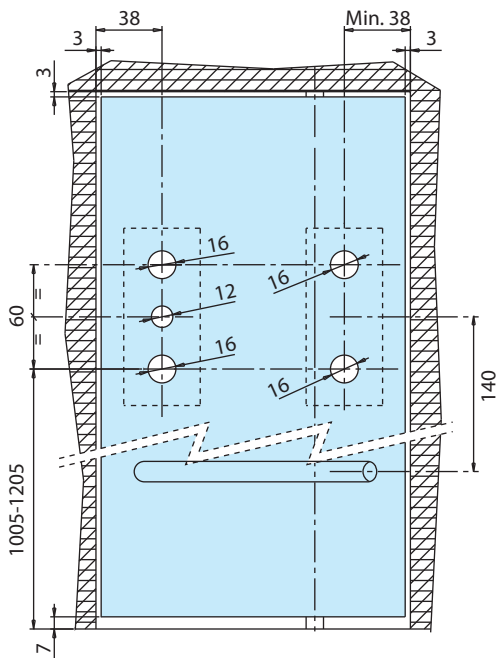

Références / References

M1040

Barre anti-panique pour sortie de secours (995 mm),
montage sur verre avec accessoire V586
Anti panic device for single glass door to fit on glass with accessory V586.



Laqué argent
Lacquered silver

M1040.73



Laqué noir
Lacquered black

M1040.52

V586



Accessoire pour montage du mécanisme
de fermeture latérale M1040 (Montage sur encoche)
*Pair of glass fitting, for side latch mechanism for M1040 panic
exit device (Assembly on notch)*



Aluminium anodisé Argent Brossé
Brushed anodised alu. silver

V586.12



Aluminium anodisé noir
Black Anodised

V586.19

Serrures anti-paniques
Anti-panic locks

AO22330 + V587

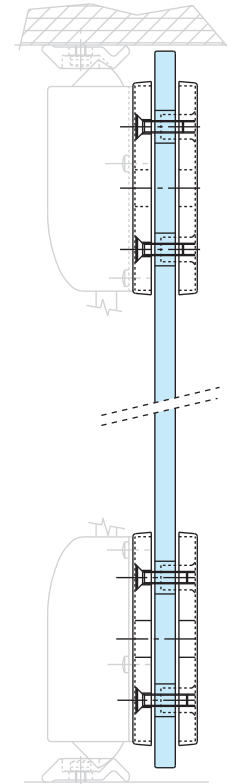
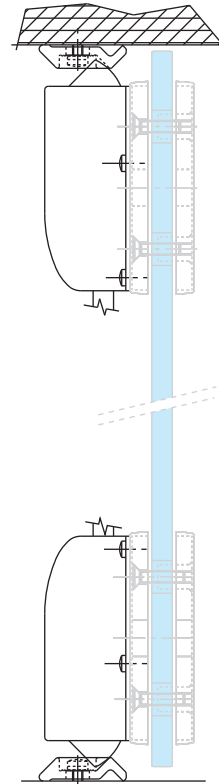
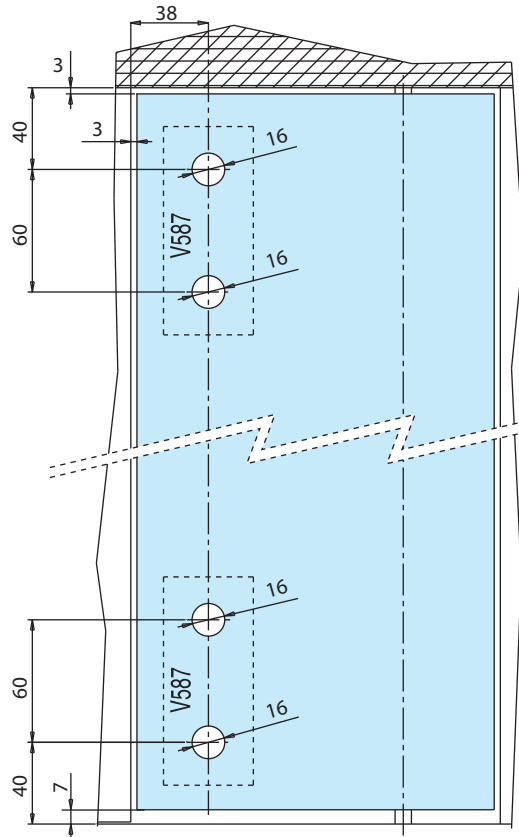

AO22330

V587

Références / References

AO22330

Mécanisme de fermeture supérieur et inférieur avec tringles et butées, pour porte jusqu'à 2500 mm, montage sur verre avec accessoire V587
Top and bottom latches, strikers and vertical rods for doors up to 2500 mm to fit on the glass with accessory V587



Laqué argent
Lacquered silver

AO22330.73



Laqué noir
Lacquered black

AO22330.52

V587



Accessoire pour montage du mécanisme supérieur et inférieur AO22330 (Montage sur encoche)
Pair of supports for top and bottom latch to fit accessory AO22330 (Assembly on notch)



Aluminium anodisé Argent Brossé
Brushed anodised alu. silver

V587.12



Aluminium anodisé noir
Black Anodised

V587.19

V588

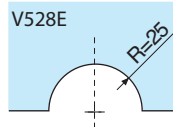
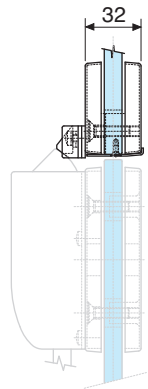

Serrures
anti-paniques
Anti-panic locks

Références / References



Boîtier gâche supérieur montage sur imposte
Matching patch keep to fit on overhead panel



Aluminium anodisé Argent Brossé
Brushed anodised alu. silver

Aluminium anodisé noir
Black Anodised

V588.12

V588.19

AO41730

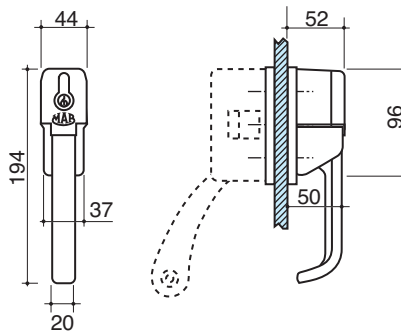

Laqué argent
Lacquered silver



Laqué noir
Lacquered black

Références / References

Poignée de manoeuvre extérieure à cylindre
(manoeuvrable avec clé uniquement). Utilisation avec M1040.
*Handle with locking cylinder (opening with key only).
Use with M104*

AO41730.73

AO41730.52

